

# NEXO

User Guide

## Install two channel switcher ( S )

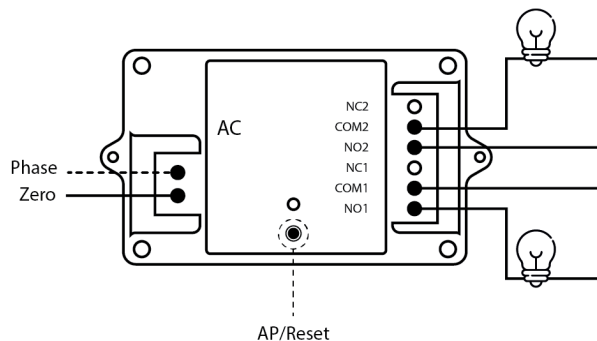

## Basic device settings

### AP mode

Hold your finger on the AP/Toggle pin for 3 seconds  
The switcher enters the Access point mode then you can start from Do it through the application.

### Toggle Status

One Click on the Ap/Toggle pin for change status switcher(on/off)

### Reset Device

Hold your finger on the Ap/Toggle pin for 7 seconds  
The switcher will restart automatically.

## WiFi Light

- Slow flashing mode means the device is running  
Trying to connect to the modem
- Fast flashing mode means AP mode
- When the Wi-Fi light is off, it means that The switcher is malfunctioning.

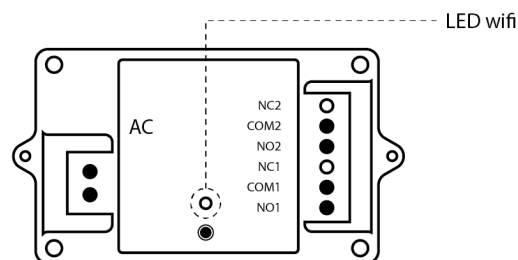

## Safety Tips

- Before installing, be sure to disconnect the main power fuse.
- Use a phase meter or insulating screwdrivers and safety gloves to connect the switcher.
- If necessary, be sure to get help from the installer to install the switcher.
- Do not install the switcher on worn and inefficient wiring.
- Prior to installation, make sure that the installation site is clean and not damp come

## Warning!!

- Avoid connecting the switch to high power appliances
- Do not install the device in humid environments separately
- Avoid connecting the device to shared or anonymous modems
- Do not install the switch in spaces with a temperature of more than 45 degrees
- Change the device password at regular intervals for device security
- Do not share your username and password with unknown individuals

## Connect switch to the application

- Download NEXO applications from reputable markets or company site.
- Install on your smartphone.
- Run the program and log in with the username and password received from the company.
- Touch the icon **+** from the left side of the app screen.

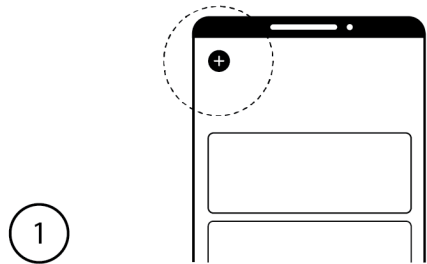

- Touch the scan QR button.
- Barcode scanning printed on switcher.
- Receive and display device information.
- Touch the next button.

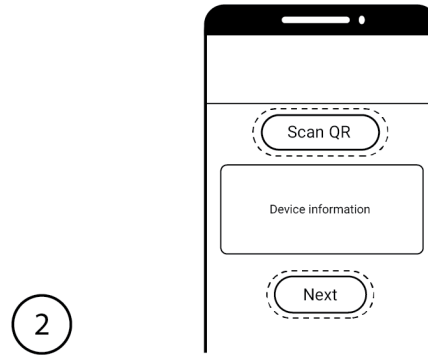

- Enter the following information as:  
SSID ----- Modem name connected to your smartphone  
Password ----- Modem connection password
- Touch the next button.

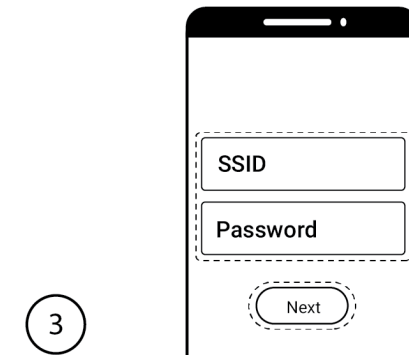

- Select the desired room of the switcher

Select one of the default rooms after completing the device setup  
Rooms are the editable location of choice.

- Touch the next button.

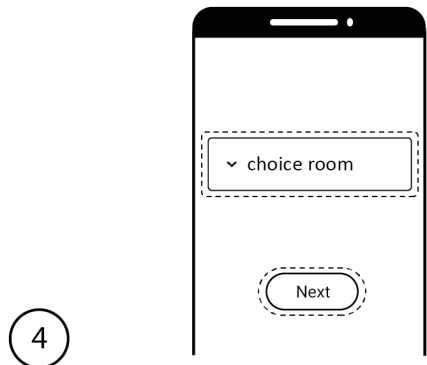

- Test the correct operation of the device by turning it on and off.
- Touch the next button.

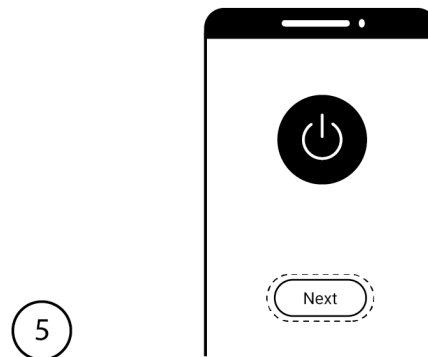

- The device has been successfully launched by displaying the tick icon.
- Touch the Finish button and enjoy working with the switcher.

